

APARTMENT NUMBER	204	304	404	504	604	704	804	904	1004	1104
LEVEL	2	3	4	5	6	7	8	9	10	11
APARTMENT NUMBER	1204	1304	1404	1504						
LEVEL	12	13	14	15						

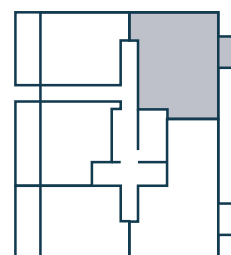

Living/Dining Room	Kitchen
5.33m x 3.72m 17'6" x 12'2"	3.10m x 2.45m 10'2" x 8'0"
Bedroom 1	Bedroom 2
5.19m x 3.35m 17' x 11'	3.83m x 3.44m 12'7" x 11'3"
Balcony	Total Internal Area
3.15m x 1.91m 10'4" x 6'3"	75.2 sq m 809 sq ft



KEY: DW = Dishwasher, FF = Fridge Freezer, HIU = Heat Interface Unit, J = Juliette Balcony, S = Store, W = Wardrobe, WD = Washer/Dryer

*Apartments 204, 304, 404, 504, 604, 704 and 804 have concrete based balconies. The floorplans depict a typical layout of this apartment type. For exact plot specification, details of external and internal finishes, dimensions and floorplan differences, consult your Sales Executive. Any areas, measurements or distances quoted are approximate only and should not be used when ordering floor coverings or furnishings. Floorplans are not shown to scale.